

SCREW DRYER

Description

Screw conveyor is the use of dry heat kerosene mechanism for conveying the material to achieve the principle of water evaporation of heating the material in the water will evaporate.

Its drying process is carried out in the space of the conveyor, etc. added to the scrubber exhaust vapor extraction device may not cause air pollution and are reliable for large conveyors cake minced dried mud cake surface is not dried cake the aqueous filtrate which in the case of a high.

Product Features

1. Processing capacity: Screw conveyors for continuous operation dry, it can handle a large number of materials.
2. Simple: to automate their own functioning.
3. Maintenance is simple: because of simple structure, it is low maintenance costs.
4. Scope: wide range of applications, operating speed can be set for the process to achieve the desired water content.



Flowchart

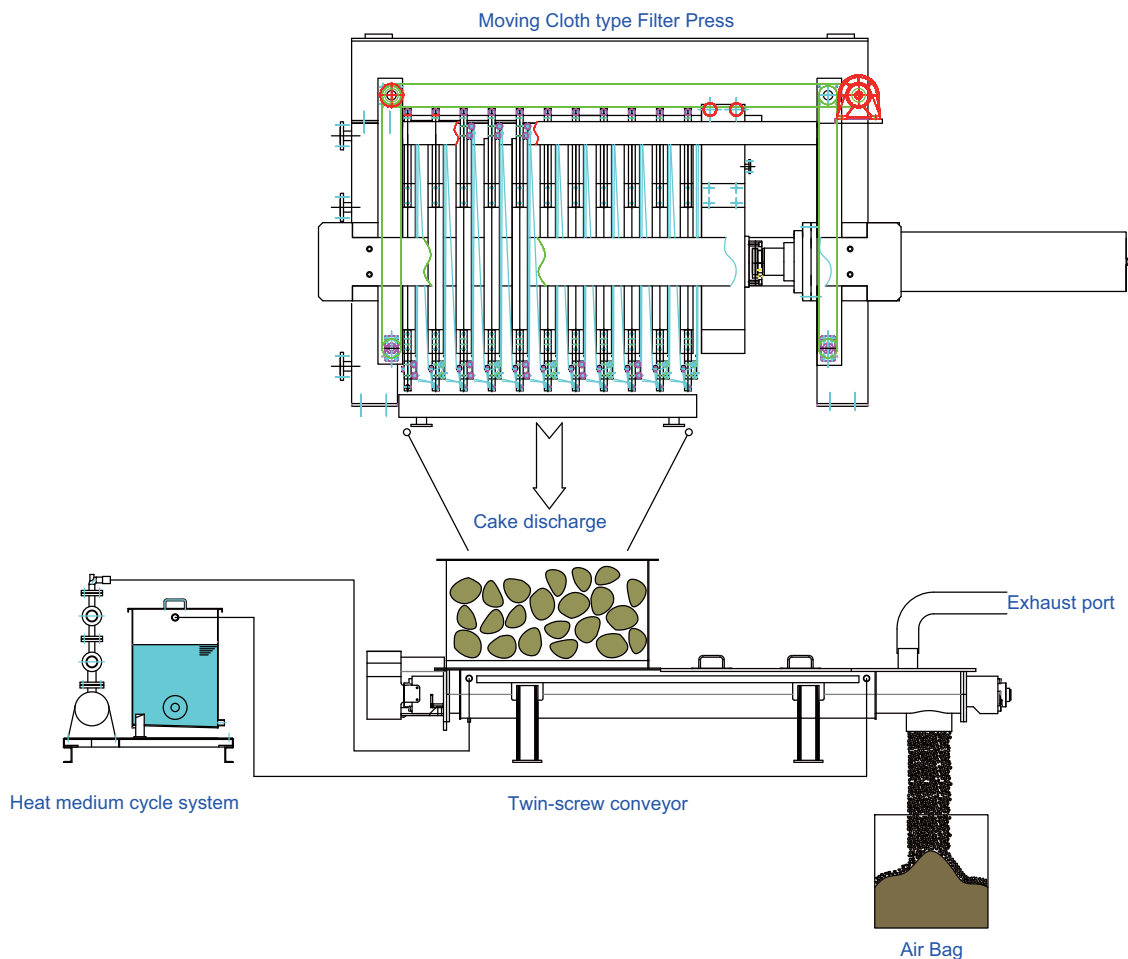

Model	Machine Dimension (mm)			capacity (Liter/Hr)
	Length	Width	Height	
SCCR200	3790	1100	1290	400

Note: Special specifications accepted

Dry screw conveyor structure description

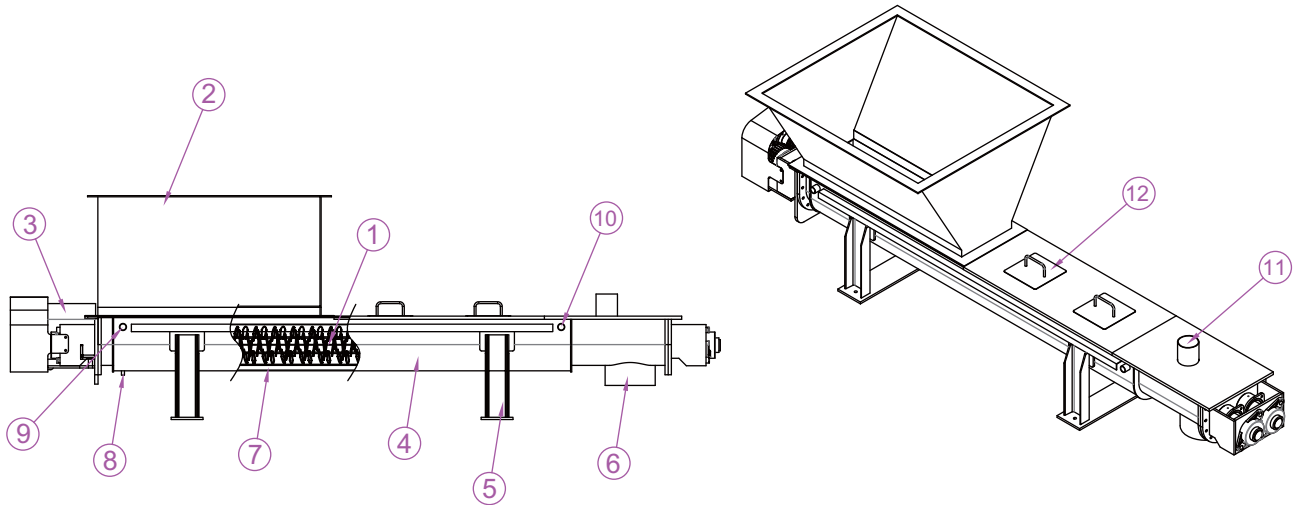

1. Screw gap
2. Hopper
3. Reducer motor
4. Heat medium Jacket
5. Foot
6. Discharge opening
7. Heat medium aisle
8. Heat medium mouth
9. Heat medium oil port into
10. Heat medium oil port out
11. Exhaust port
12. Patrol mouth

Dry Screw conveyor mechanism made description

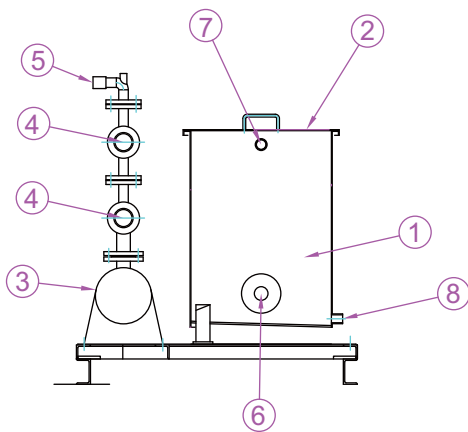

1. Heat medium tank
2. Heat medium cover
3. Heat medium pump
4. Heater
5. Heat medium outlet (connect with conveyor)
6. Heat medium outlet (connect with pump)
7. Heat medium inlet
8. Heat medium mouth.